

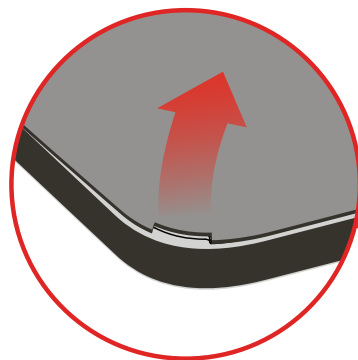

Get connected
Vodafone
Pocket WiFi® 4G (R216)
Vodafone
Power to you

Your Vodafone Pocket WiFi®
network name & password

SSID sticker here

1 Open



2 Insert SIM & battery

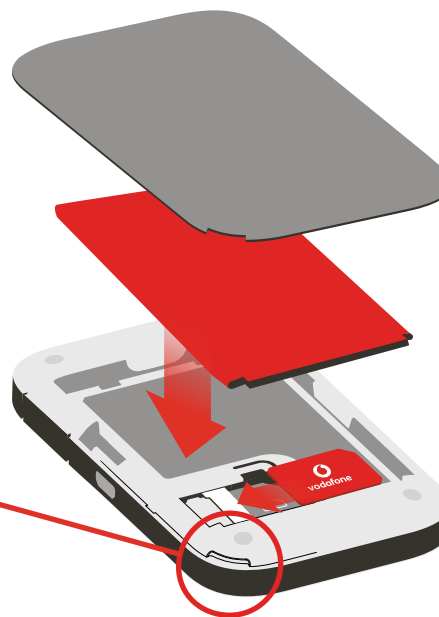

3 Charge

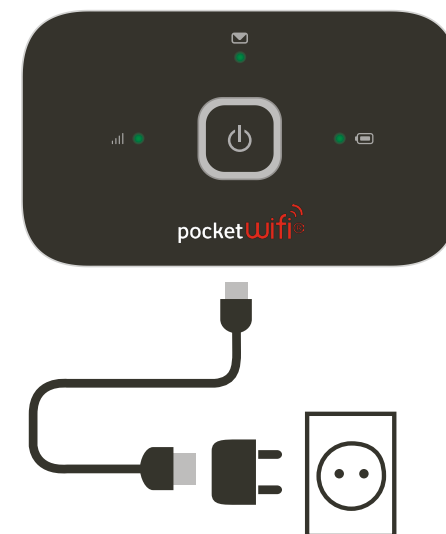

Note: you can use your computer's USB port for power as well.

4 Start

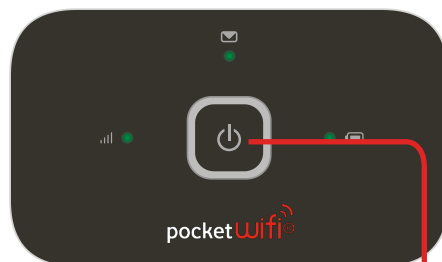

Push and hold the power key

5 Connect

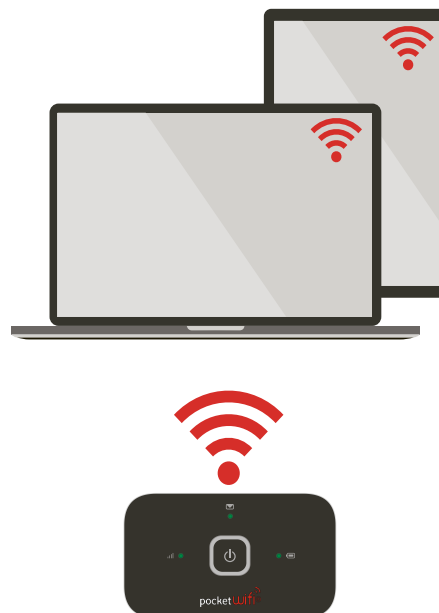

Choose WiFi on your computer, smartphone or tablet settings, then select your Pocket WiFi® network name (SSID).

Enter the password to connect and open the online dashboard.

When you first connect to the network you may be asked to activate your SIM. If you're asked to unlock your SIM card, go to <http://pocket.wifi> and enter the PIN for your SIM.

Turn over for more information about using your Vodafone Pocket WiFi®.

Using the online dashboard

Vodafone Pocket WiFi® online dashboard

Go to <http://pocket.wifi> if the Online Dashboard doesn't automatically appear when you connect.

Navigation tabs

Select Pocket WiFi® for an overview, SMS for messages, or Account for your account details.

Inbox

You have no current messages

Vodafone Pocket WiFi help

In the Current Network section you will find all details relevant to your current connection. Within this section you can easily check to confirm that you can access the internet. You are successfully connected to the internet

Important items to check include:
1. SIM is inserted correctly
2. If "Searching for Network..." is continually showing, try moving to another physical location, nearer a

Should you still be unable to connect please [consult the help section](#) for further advice

Help

This section gives you full details of how to resolve any issues.

Login

This lets you see additional information and make changes.

Use the password 'admin' to log in.

Please note: you can change the default password if required. Go to 'Help' to find out how.

Status panel

This lets you see the status and other details about your Vodafone Pocket WiFi® and its network.
(Note:  = limited network service.)

What do the lights mean?







Mobile broadband signal

-  Good
-  Weak
-  No network

SMS messages

-  New SMS
-  (Blinking) Inbox full

Battery charge

-  Good
-  (Blinking) Charging
-  Low
-  (Slow breathing) Standby

Note: while updating your device all the lights will blink green until restarting.

To find out more about your device, please visit vodafone.com/R216

Download the monitor app

The Vodafone Pocket WiFi® Monitor app is a quick and easy way to monitor your network on a smartphone or tablet.

Download the app or scan the appropriate QR code here to take you to that app store. Please note: You'll first need to install a QR code reader on your smartphone.

iOS
(iPhone or iPad)



Android
(smartphone or tablet)



The term "Mobile Broadband" together with the 'birds' design is a trademark of GSMC Limited.

You have purchased a product which uses source code of software licensed under the GNU General Public License (GPL) or Lesser GNU General Public License (LGPL) or some other open source licenses allowing source code distribution to you. We offer you a complete copy of the corresponding source code, which is available for download within a period of three years from the distribution of the product and is free of charge. You may download the source codes from <http://vodafone.com/R216>

© Vodafone Group 2015. Vodafone and the Vodafone logos are trade marks of Vodafone Group. Any product or company names mentioned herein may be the trade marks of their respective owners.