

SMART HOME MONITORING



# Outdoor Day/Night Camera

Manufacturer's Installation Guide

# Installation



## 1. Attach the Outdoor Camera's Antenna

- › Attach the antenna to the Outdoor Camera by turning it clockwise.
- › Put the antenna in the upright position to improve wireless reception.

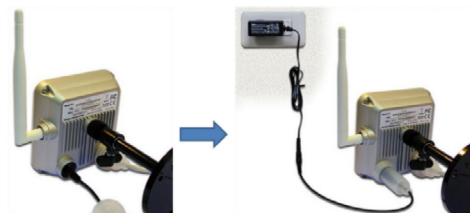

## 2. Power On The Outdoor Camera

Plug the power adapter into the back of the camera and connect the water sealing cap until it is attached securely. Plug the adapter end into a power outlet.

**Note:** Only use the power adapter provided. Using a different adapter may cause hardware damage.